

LAND FOR SALE



36+ ACRES AVAILABLE IN MONTGOMERY, ALABAMA

This property is centrally located near downtown Montgomery; Maxwell Airforce Base; and I-65 with access from Day Street. Zoned Industrial and available for urban development including residential, multifamily, or light and heavy industrial. This is one of a few large sites available in the downtown area.

Offered at \$370,000

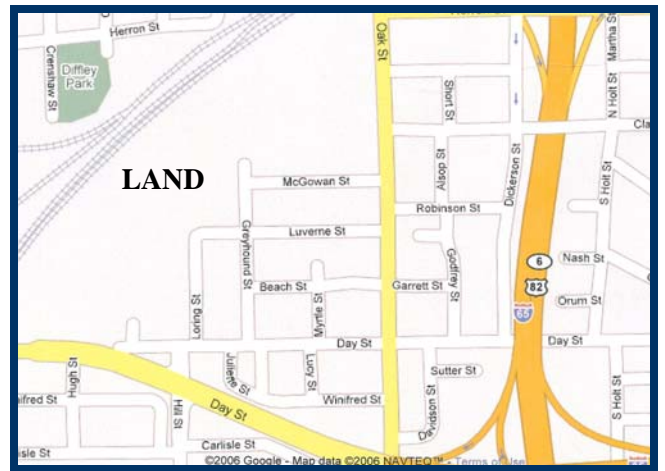

Contact Information

Richard L. Crunkleton, CCIM

(256) 536.8809 Office

(256) 679.1969 Mobile

(256) 536.9119 Fax

Email: Richard@CrunkletonAssociates.com

201 Williams Avenue, Suite 200

Huntsville, AL 35801

www.CrunkletonAssociates.com

CRUNKLETON & ASSOCIATES, LLC

COMMERCIAL INVESTMENT REAL ESTATE

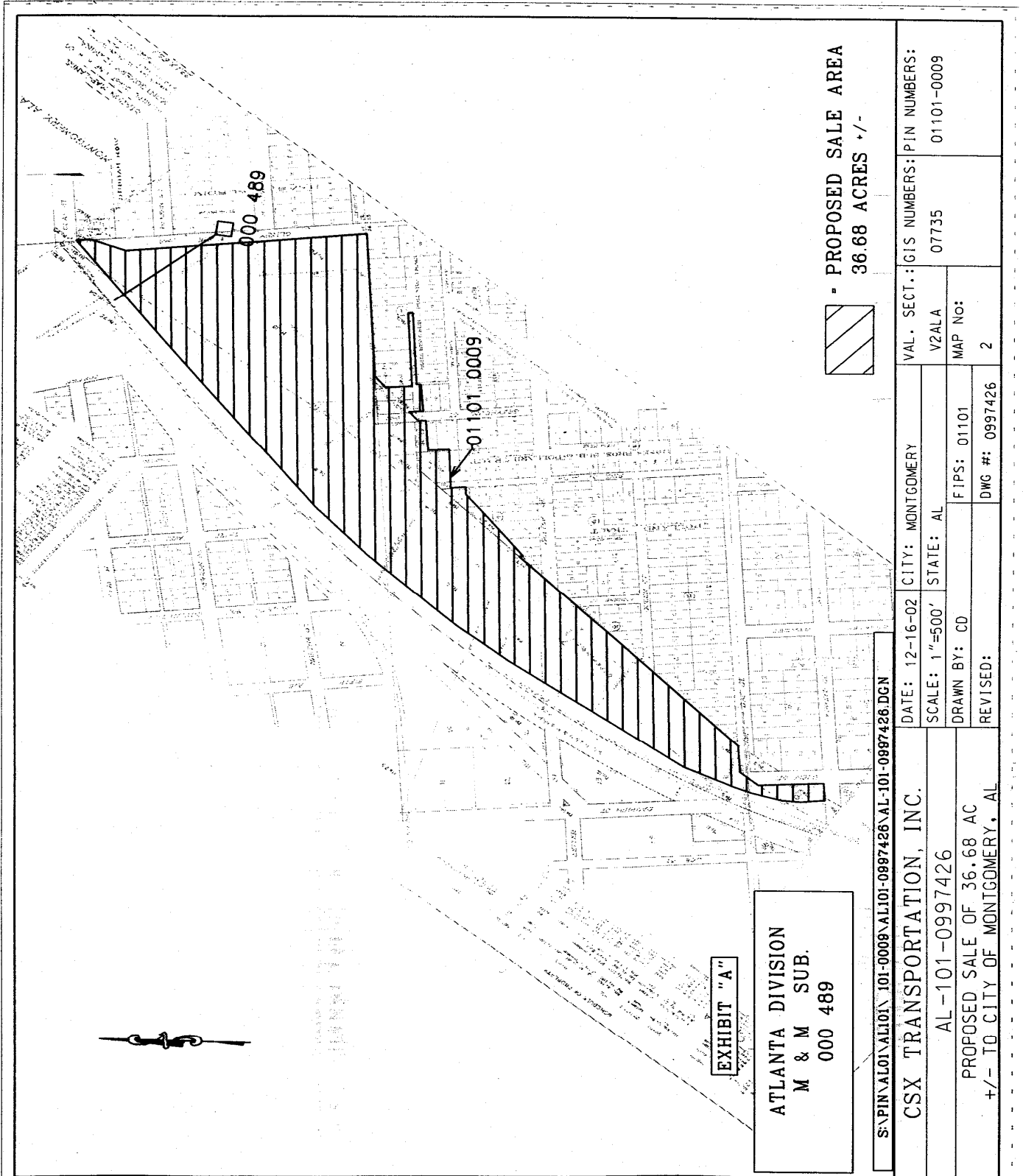

PHONE: 256.536.8809

FAX: 256.536.9119